

## Data sheet Product ISAS 60 C



Accessories for electronic components > Fixing material for mechanical components > Distance sleeves and spacers  
double internal Thread

### Features

<b>version</b>	insulating spacer with internal and external thread
<b>creeping current resistance</b>	CTI 600
<b>thread inserts</b>	brass
<b>surface</b>	raw
<b>temperature range</b>	-30°C... +85°C (short term +200°C)
<b>plastic body</b>	polyamide 66
<b>colour</b>	natural (opaque)
<b>dielectric strength</b>	27 kV/mm

### Technical Drawing

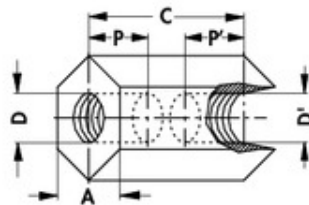

<b>D/D' [mm]</b>	M6/M6
height	12.7
<b>A [mm]</b>	
<b>length C [mm]</b>	25 / 30 / 35 / 40 / 45 / 50 / 60
<b>P/P' [mm]</b>	12.7